

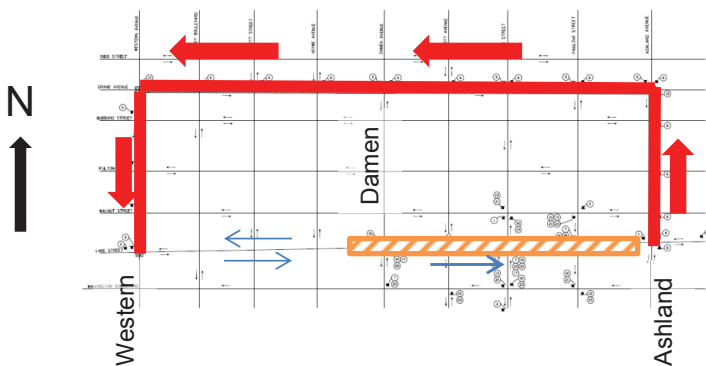

## Lake Street Construction Damen to Ashland

- Reconstruction and lowering of the pavement up to 1' to improve clearance, CTA column relocation at Damen/ Lake, streetscape including lighting, sidewalk, trees
- Construction Start: April 2018
- End: December 2018
- Closures and Detours: N. Damen Ave., one lane to be maintained in each direction
- WB Lake Street detoured via Ashland Ave. to Grand Ave. to Western Ave. for duration of project until resurfacing which will start in October 2018; March 2018 - October 2018
- EB Lake Street detoured to Grand via Western Ave./ Ashland Ave. during CTA column relocation. One lane east bound maintained May 2018 - September 2018



Detour for WB Lake St. (EB only)  
Damen to Ashland  
March to October 2018

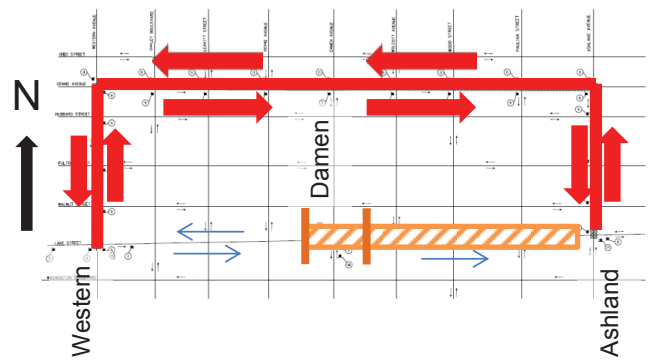

Detour for EB/WB Lake St.  
May to September 2018  
No traffic through Damen intersection

